

# O2 Mk9 Detector Base SET (2056)

## O2 Safety System SET with amber Horn/Strobe



### TECHNICAL DATA

<b>Power supply:</b>	12-24V DC
<b>Number of sensors:</b>	1-4
<b>Communication:</b>	RS485 Modbus
<b>Automatic calibration:</b>	Several times a year

For further data see separate data sheets for the specific components.

### ORDERING EXAMPLE

Description	Item code
O2 Mk9 Detector SET	2056

### O2 Mk9 Detector SET consists of:

- Mk9 Central Unit
- Cable red 5m
- O2 Sensor Mk9
- Cable red 10m
- Cable blue 5m
- Horn/Strobe LED amber with 1m cable
- RJ45 1-1 split
- RJ45 1-2 split
- Transformer 1A
- Plug-UL for transformer
- Plug-CE for transformer
- Plug-AU for transformer
- Plug-UK for transformer
- Plug-lock
- Bag with 6 screws and plug
- Sign O2 Safety System Mk9
- Sign Horn/strobe Mk9
- Installation manual O2 Mk9

### FUNCTION

The LogiCO2 oxygen sensor (O2) has a FBO oxygen sensor with built-in temperature and pressure adjustment. The oxygen sensor is factory calibrated and measures the ambient oxygen partial pressure (ppO2) levels. The sensor benefits from low power operation and a long lifetime (> 5 years) due to the nondepleting sensing principle.

The basic O2 Safety System is an instrument comprising one central unit (with a digital display), one (up to four) sensor unit, one horn/strobe. A separate electronic transformer supplies power to the system. The system provides visible indication of O2 levels and in the area where the remote sensor is located. It is displayed on a screen of the Central Unit in most languages. Explaining what to do in different Alarm situations. The O2 Safety System performs a self-calibration at regular intervals insuring calibration under normal circumstances. This eliminates the need of manual service calibration in a normal environment. A manual start up calibration is however needed.

Installed properly, the O2 sensor will continuously monitor the O2 concentration that it is exposed to. A light emitting diode (LED) indicates that the O2 sensor is running properly. If ambient conditions at the O2 Sensor reach a O2 concentration level below 19.5% (preset evacuation alarm), the central unit will emit a constant audible tone and the « high alarm » red LED lights. A remote Horn/Strobe will flash and sound.

The O2-sensor has a backlit display showing the current O2 concentration and the uptime (measure of operating time) in hours.

### ALTITUDE ADJUSTMENT

The LogiCO2 Mk9 O2 sensor has altitude compensation.

### ALARM LEVELS

The default alarm level setting on the O2 sensor is:  
A-alarm (Evacuation alarm) at 19.5% O2.

The O2 sensor can be set to make an alarm at three different levels to comply with all local Safety Codes and legislations. Two B-alarms (service alarm) and one A-alarm (evacuation alarm) can be set.

For example:  
B-Alarm at 19,5% O2  
B-Alarm at at 23% O2  
A-Alarm at 18% O2

**Connection diagram**

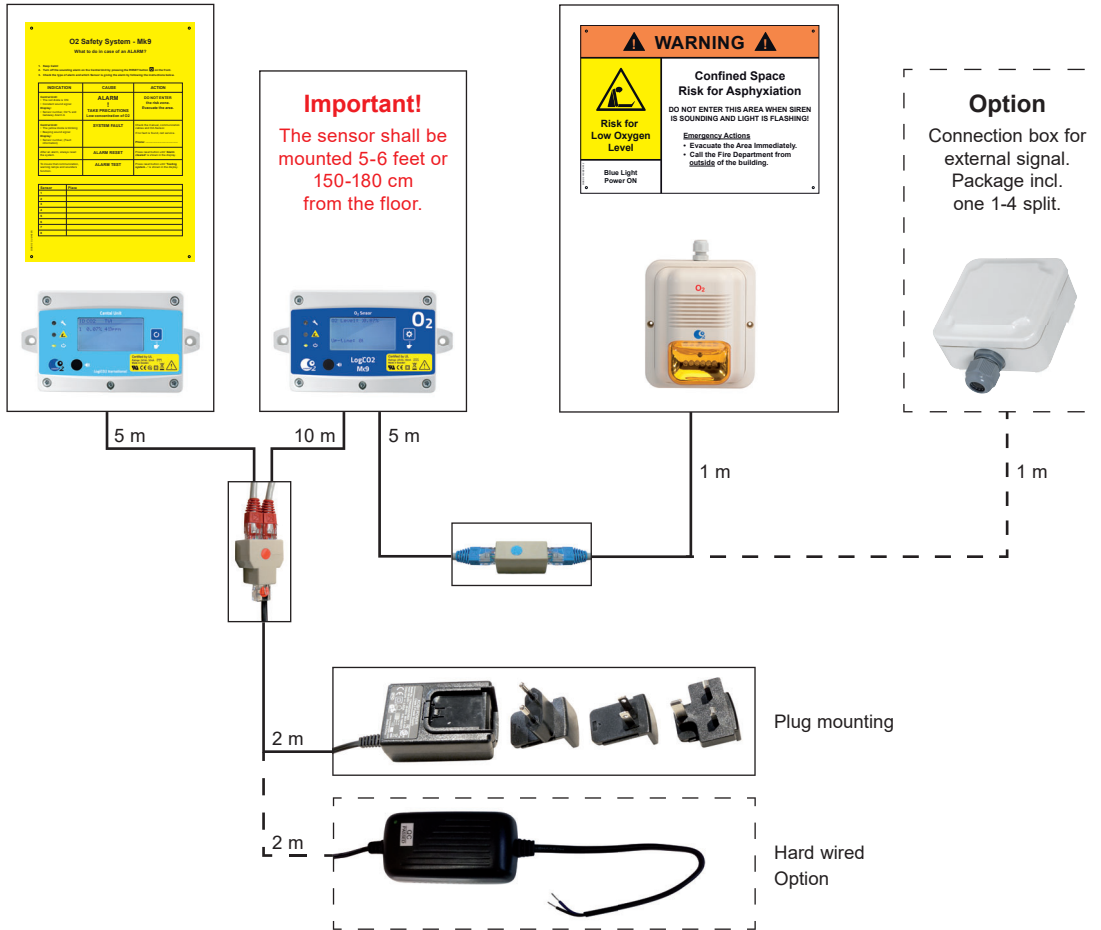

**CABLE EXTENSION CONNECTOR**

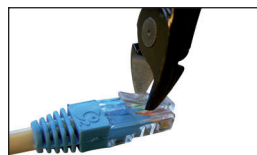
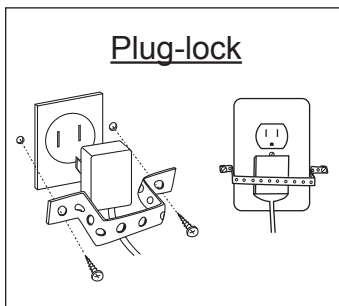
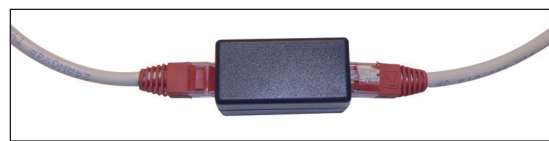
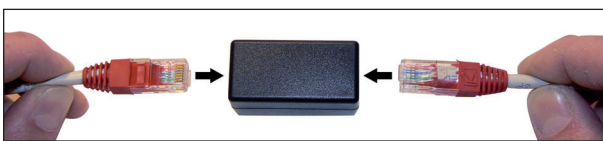

Cut off the prolongations of the lock-release on the RJ45 connectors to secure unauthorized disconnection of the O2 Safety System.

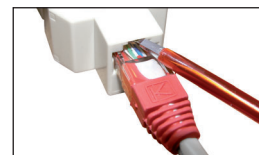

Use a small screwdriver to disconnect the RJ45 plugs.